

Ficha Técnica Salones

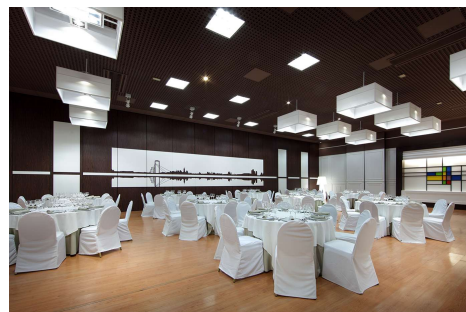
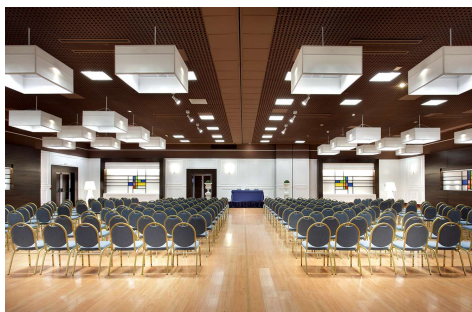
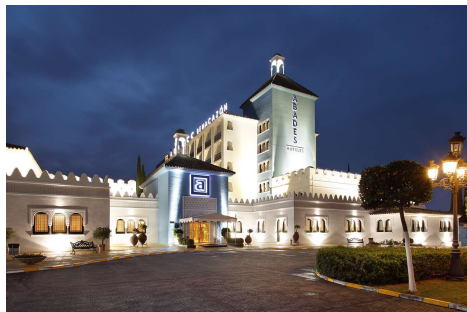

GALA

TEATRO

ESCUELA

EN U

IMPERIAL

COCKTAIL

M2

ALTURA

DIMENSIONES
(LxA)

Salón Alcazaba	350	500	350	70	70	400	454	4,50	22.95 x 20.98
Salón Arrayanes	100	150	100	45	50	120	210	3,25	17.81 x 11.79
Salón Guadaira	40	90	60	34	34	60	67	2,55	12,40 x 5,56
Salón Aljarafe	15	35			20	25	30	2,55	10,00 x 3,00
Salón Alhamar	15	30			15	20	25	2,55	6,43 x 3,90
Salón Emir	15	35			20	25	36	2,55	6,43 x 5,56
Salón Almazor	20	40			25	30	40	2,55	6,70 x 5,80
Salón Nazarí	15	35			20	25	70	2,55	6,50 x 10,50
Salón Generalife	25	40			22	35	47	2,55	5,60 x 8,30
<i>Zona Exterior</i>									
Jaima	130					250			
Lago	100					200			
Jardines						100			
Piscina						300			

Salones de mayor capacidad:

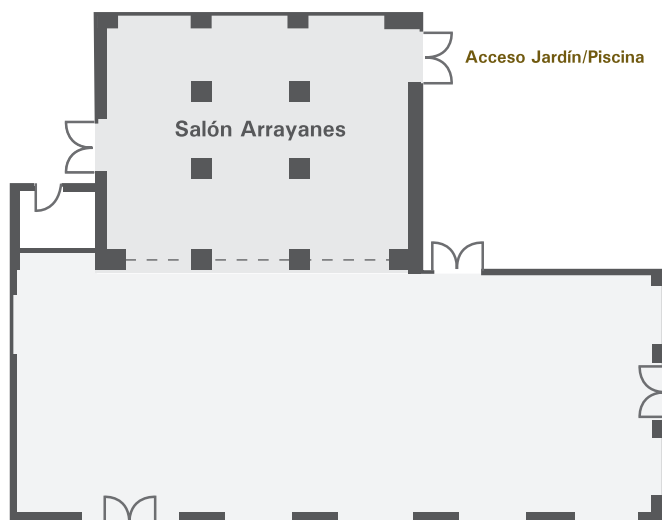

Salón Alcazaba

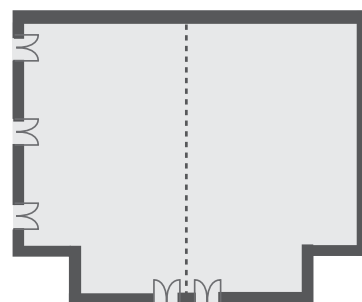

Acceso Zona Ajardinada

SERVICIO WIFI